

# WELLINGTON INTERNATIONAL

ESP SPRING II – April 8-12, 2026

Competition No.: 707

Jr/Am Jumper 1.40m

Competition against the clock

Table: Speed  
National RG: II 2.1  
FEI RG / Art.  
Height: 1.40 m

Speed: 350 m/min  
Length: 430 m  
Time allowed: 74 sec  
Time limit: 148 sec

Obstacles: 1 - 12  
Efforts: 14

1st Jump-off:

Length: 0 m  
Time allowed: 0 sec  
Time limit: 0 sec

Saturday, April 11<sup>th</sup>, 2026



1

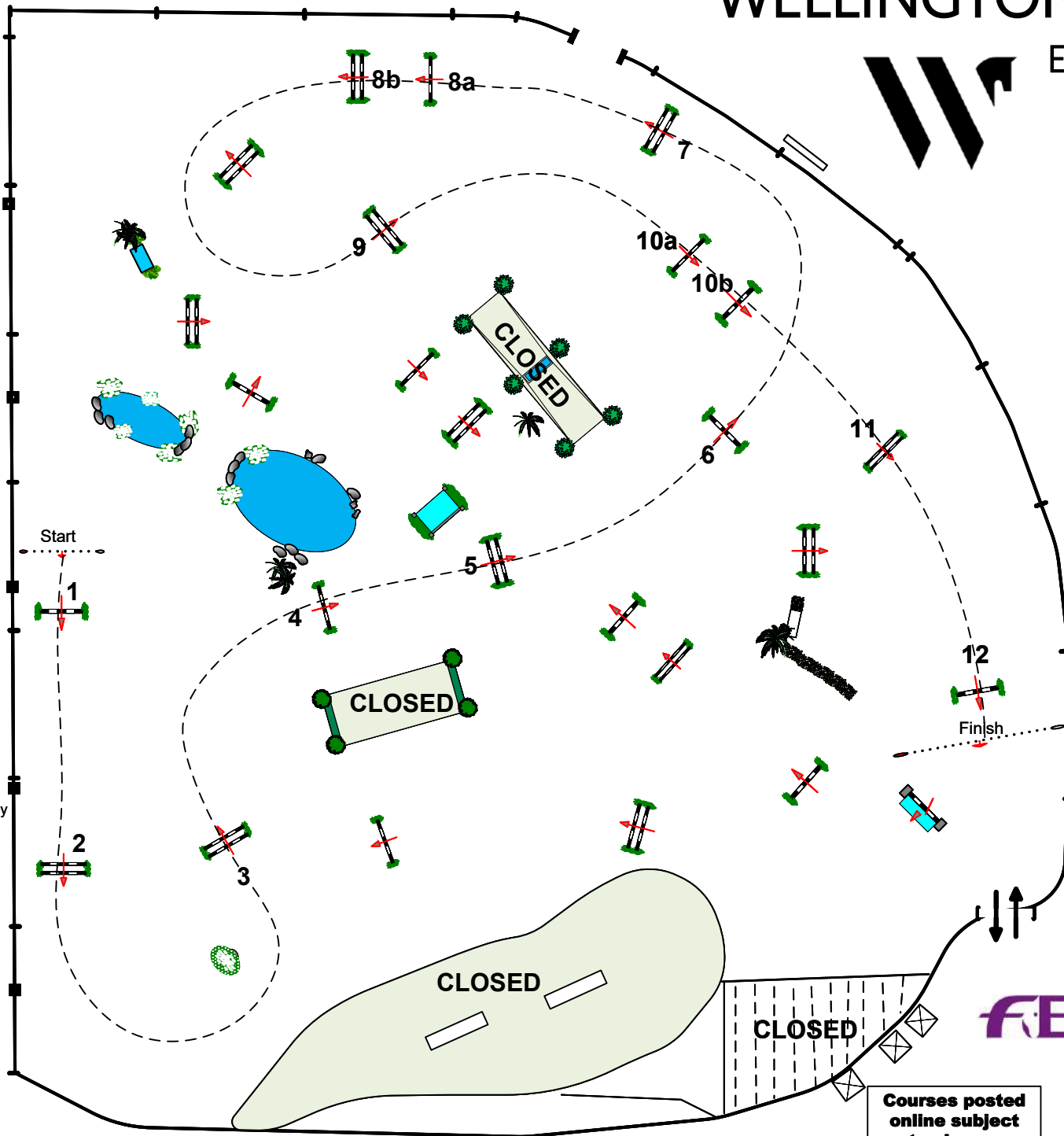

Courses posted online subject to change

# WELLINGTON INTERNATIONAL

ESP SPRING II – April 8-12, 2026

Competition No.: 3013

FEI \$32,000 1.45m Classic

Competition against the clock

Table: Speed  
 National RG: II 2.1  
 FEI RG / Art. 220.2.1.1  
 Height: 1.45 m

Speed: 375 m/min  
 Length: 505 m  
 Time allowed: 81 sec  
 Time limit: 162 sec

Obstacles: 1 - 12  
 Efforts: 15

1st Jump-off:

Length: 0 m  
 Time allowed: 0 sec  
 Time limit: 0 sec

Saturday, April 11<sup>th</sup>, 2026

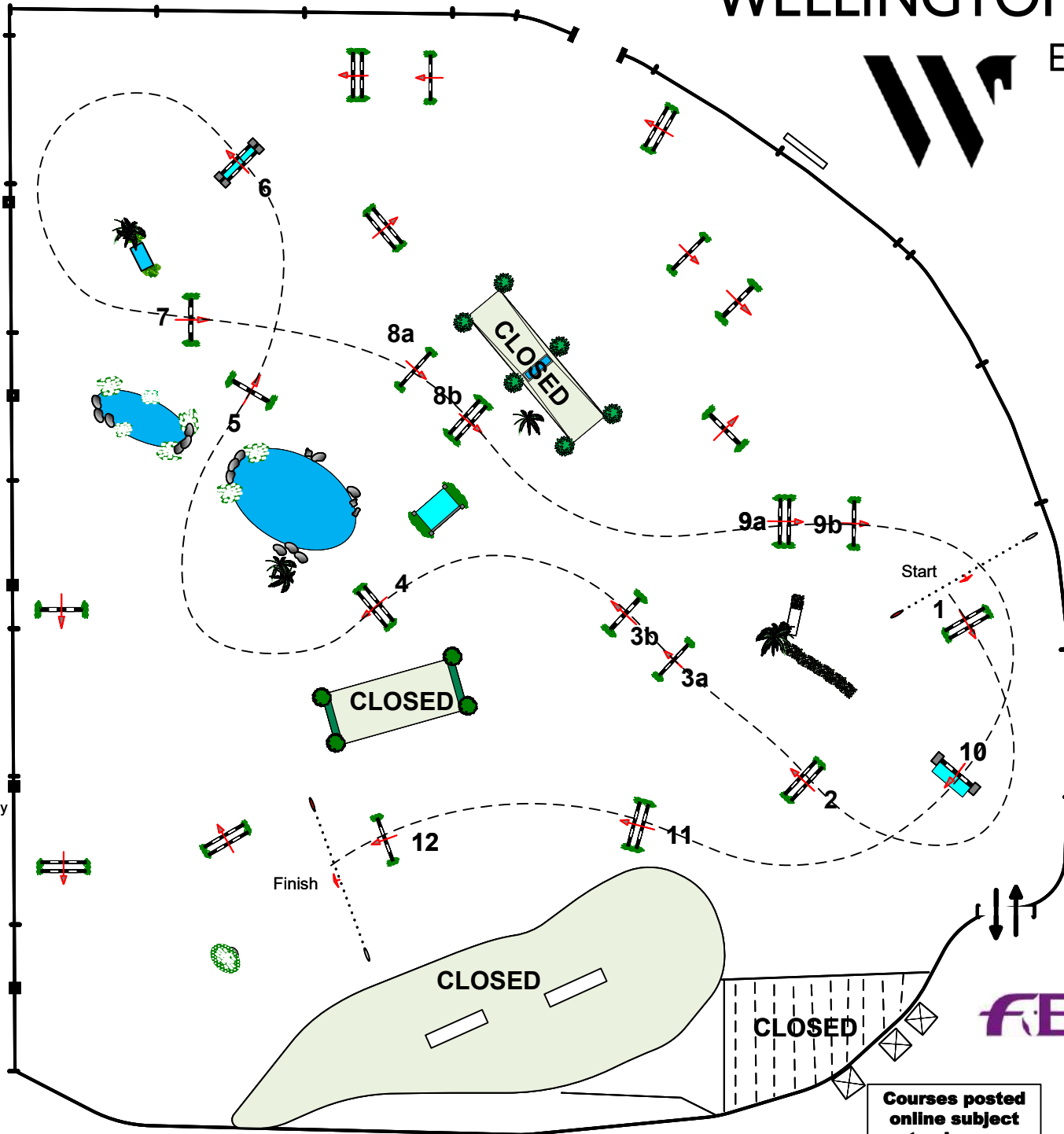

Courses posted online subject to change



2

